

New PRO9 and PRO9FXL Air Cooled Pro-Grip™ TIG Welding Torch

Rating: 125A DC, 100A AC @ 60% Duty Cycle, EN60974-7 .020" to 3/32" 0.5mm-2.4mm Electrodes

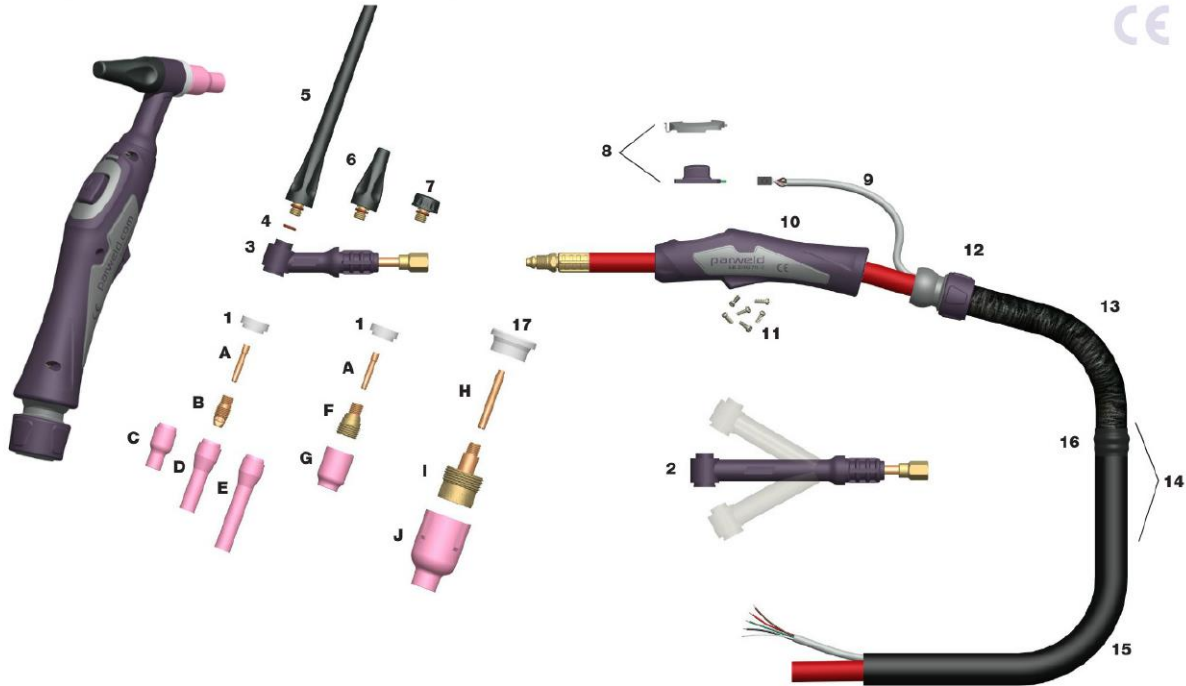

Pro-Grip™

Torch Head		
Stock Code	Description	
PRO9	PRO9	Torch Head Air Cooled 125A DC
PRO9FXL	PRO9FXL	Torch Head Flexible Air Cooled 125A DC

Cable Length		
Stock Code	Description	
12	12.5ft Cables (4m)	c/w Leather Cover and Sheath
25	25ft Cables (8m)	c/w Leather Cover and Sheath

Switch Option		
Stock Code	Description	
S1	Momentary Switch	
S1L	Momentary Switch and Lever	
S2	2 Button Momentary	
S3	3 Button Momentary	
S4	4 Switch Momentary Rocker Kit	
1K	1 Button Momentary +1K Potentiometer	
2K	1 Button Momentary +5K Potentiometer	
3K	1 Button Momentary +10K Potentiometer	
4K	1 Button Momentary +25K Potentiometer	
N	Blank	

Cable Termination		
UK/European Cable Termination		
Stock Code	Description	
BG	Single 3/8" BSP Connection	
EG	Central Connector	
WG	WTG Connector	
LG	L-TEC Euro	
BD	35-50 Dinse on Power 3/8" BSP on gas	

USA Cable Termination		
Stock Code	Description	
US	Lug on power, 5/8" UNF RH Male on Gas	
UN	Single 5/8" UNF RH male	
UD	35-95 dinse on power, 5/8" UNF RH Male on Gas	

Cable Plug		
Stock Code	Description	
0	2 Pin Amphenol Plug	
1	4 Pin Amphenol Plug	
2	5 Pin Amphenol Plug	
3	6 Pin Amphenol Plug	
4	14 Pin Amphenol Plug	
5	6 Pin Harting Plug	
6	8 Pin Thermal Arc Plug	
7	3 Pin Tuchel Plug	
8	9 Pin Tuchel Plug	
9	5 Pin Tuchel Plug	
10	12 Pin Bundy Plug	
11	7 Pin Migatronic Plug	
12	2 Pin XTI Inverter Plug	
14	5 Pin XTI Inverter Plug	

PROLINE

professional welding supplies

Standard Collet

Stock Code Description

A	13N20	Standard Collet .020"/0.5mm Bore
	13N21	Standard Collet .040"/1.0mm Bore
	13N22	Standard Collet 1/16"/1.6mm Bore
	13N22M	Standard Collet 5/64"/2.0mm Bore
	13N23	Standard Collet 3/32"/2.4mm Bore

Standard Collet Body

Stock Code Description

B	13N25	Standard Collet Body .020"/0.5mm Bore
	13N26	Standard Collet Body .040"/1.0mm Bore
	13N27	Standard Collet Body 1/16"/1.6mm Bore
	13N27M	Standard Collet Body 5/64"/2.0mm Bore
	13N28	Standard Collet Body 3/32"/2.4mm Bore

Standard Ceramic Cup

Stock Code Description

C	13N08	Standard Ceramic Cup 1/4"/6mm Bore
	13N09	Standard Ceramic Cup 5/16"/8mm Bore
	13N10	Standard Ceramic Cup 3/8"/10mm Bore
	13N11	Standard Ceramic Cup 7/16"/11mm Bore
	13N12	Standard Ceramic Cup 1/2"/15mm Bore
	13N13	Standard Ceramic Cup 5/8"/16mm Bore

Long Ceramic Cup

Stock Code Description

D	796F70	Long Ceramic Cup 3/16"/5mm Bore
	796F71	Long Ceramic Cup 1/4"/6mm Bore
	796F72	Long Ceramic Cup 5/16"/8mm Bore
	796F73	Long Ceramic Cup 3/8"/10mm Bore

Extra Long Ceramic Cup

Stock Code Description

E	796F74	Extra Long Ceramic Cup 3/16"/5mm Bore
	796F75	Extra Long Ceramic Cup 1/4"/6mm Bore
	796F76	Extra Long Ceramic Cup 5/16"/8mm Bore
	796F77	Extra Long Ceramic Cup 3/8"/10mm Bore

Gas Lens Body

Stock Code Description

F	45V41	Gas Lens Body .020"/0.5mm Bore
	45V42	Gas Lens Body .040"/1.0mm Bore
	45V43	Gas Lens Body 1/16"/1.6mm Bore

Gas Lens Cup

Stock Code Description

G	53N58	Standard Gas Lens Cup 1/4"/6mm Bore
	53N59	Standard Gas Lens Cup 5/16"/6mm Bore
	53N60	Standard Gas Lens Cup 3/8"/8mm Bore
	53N61	Standard Gas Lens Cup 7/16"/10mm Bore
	53N61-S	Standard Gas Lens Cup 1/2"/13mm Bore

Large Diameter Gas Lens Collet

Stock Code Description

H	13N22L	Large Dia Gas Lens Collet 1/16"/1.6mm Bore
	13N23L	Large Dia Gas Lens Collet 3/32"/2.4mm Bore

Large Diameter Gas Lens Body

Stock Code Description

I	45V116S	Large Dia Gas Lens Body 1/16"/1.6mm Bore
	45V64S	Large Dia Gas Lens Body 3/32"/2.4mm Bore

Large Diameter Gas Lens Cup

Stock Code Description

J	57N75	Large Dia Gas Lens Cup 3/8"/10mm Bore
	57N74	Large Dia Gas Lens Cup 1/2"/13mm Bore
	53N88	Large Dia Gas Lens Cup 5/8"/16mm Bore
	53N87	Large Dia Gas Lens Cup 3/4"/19mm Bore

Components

Stock Code Description

1	598882	Cup Gasket
2	PRO9FXL	Torch Head Flexible
3	PRO9	Torch Head including Cup Gasket
4	98W77	Back Cap O Ring
5	PRO41V24	Pro-Grip™ Tig Back Cap Long
6	PRO41V35	Pro-Grip™ Tig Back Cap Medium
7	PRO41V33	Pro-Grip™ Tig Back Cap Small
8	PRO1MS	Momentary Switch Kit (fitted as Standard) Alternative switch options are listed on Page 137
9	PROSWL4	Switch & Leads x 4mt/12.5ft
	PROSWL8	Switch & Leads x 8mt/25ft
10	PROH100	Pro-Grip™ Tig Handle Small
11	PROSP	Screw Pack
12	PROKJ100	Knuckle Joint c/w Lock Nut
13	PROLC100-08	Leather Cover x 0.8mt/2.6ft
14	PROCO100-40	Complete Cover Assembly x 4mt/12.5ft
	PROCO100-80	Complete Cover Assembly x 8mt/25ft
15	PRONC32	Neoprene Cover x 3.2mt/10.5ft
	PRONC72	Neoprene Cover x 7.2mt/23.6ft
16	PROJK100	Jointing Repair Kit
17	54N63-20	Insulator Large Diameter Gas Lens

Ph: 0800 699 353

sales@prolinewelding.com